

# EZ-CARD®

## High-Density Polyethylene (HDPE) Packaging



### **Elevate your packaging to a thin, lightweight, recyclable design.**

EZ-Card®, also known as backer cards, mounting cards, HDPE cards, die cut inserts, or insert cards, are designed to safely and securely hold medical instruments and devices utilizing our proprietary EZ-Clip™ injection molded clips, along with other retainment options such as die cut tabs, slots, folds, and straps. Manufactured from thin, lightweight high-density polyethylene (HDPE), EZ-Card is a cost-effective and space saving packaging alternative to trays and other commonly used packaging options.

Due to their thin, flat, flexible design, EZ-Card pairs well with sterilization pouches to provide a double barrier packaging system.

For medical devices that may require an extra level of sterile barrier protection, our FlexShield® thermoplastic polyurethane (TPU) film packaging provides outstanding puncture and abrasion resistance when paired with EZ-Card.



### **Applications**

- Catheters
- Guidewires
- Trocars
- Needles
- Medical tubing
- Laparoscopic devices
- Laboratory instruments

## Securing Options

- **EZ-Clip™:** Our proprietary injection molded clips used to hold a wide range of instruments.
- **Tabs:** Commonly used as a retention feature for lightweight applications such as guidewires.
- **Protective folds:** Provides additional protection for sensitive medical devices and instruments.
- **Straps:** Used to securely hold larger medical devices and tubing.
- **Slots:** Ideal for securing devices and instruments such as trocars, needles, catheters and more.

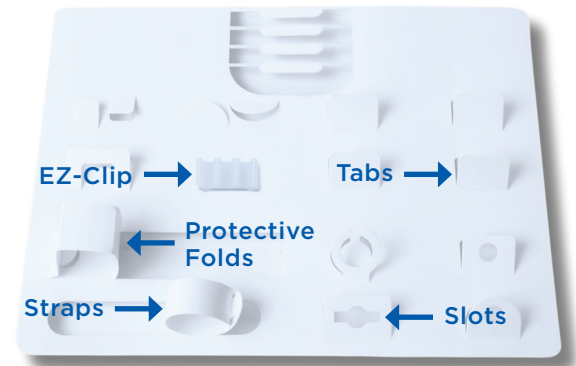

## EZ-Card Advantages



### Speed to Market

Rapid prototypes in 24-72 hours as well as a range of available standard sizes.



### Space Saving

Thin HDPE material stores and ships flat, maximizing storage and transportation efficiency.



### Cost-Effective

Reduced tooling and material expenses compared to traditional thermoformed trays.



### Sustainable

Made from 100% recyclable HDPE.



## Material Details

EZ-Card is manufactured from high density polyethylene (HDPE) which is ideal for medical packaging applications due to its lightweight, low-profile, flexible, and crack resistance properties.

- **Gauges:**
  - + 0.020" (0.51 mm)
  - + 0.023" (0.58 mm)
  - + 0.028" (0.71 mm)
  - + 0.035" (0.89 mm)
- **Colors:** White
- **Finishes:** Matte and gloss
- **Printing:** Silk screen, hot stamp, and laser ink jet
- **USP Class VI certified resin**
- **Compliant with FDA requirements**

